

NEELADRI VILLAS



EXCLUSIVE GATED COMMUNITY

400 sq.yds

LARGE PLOT SIZE

72' x 50'

Each plot measures approximately 400 sq.yds.
Giving ample space for your desired living.

SPACIOUS ROADS

30' & 40'

Black top roads. 40 feet width main road. 30 feet width sub-roads.

3600 sft

TRIPLEX

Ground + First + Second Floors. A place for your everything you own.

HMDA Approved

Layout and building will approved by HMDA and built as per NBC norms.

EAST & WEST Facing only

All villas in the layout are either east or west facing and as per vastu.

LAVISH SPACE between Villas

A minimum of 15 feet gap between villas, giving priority to your privacy



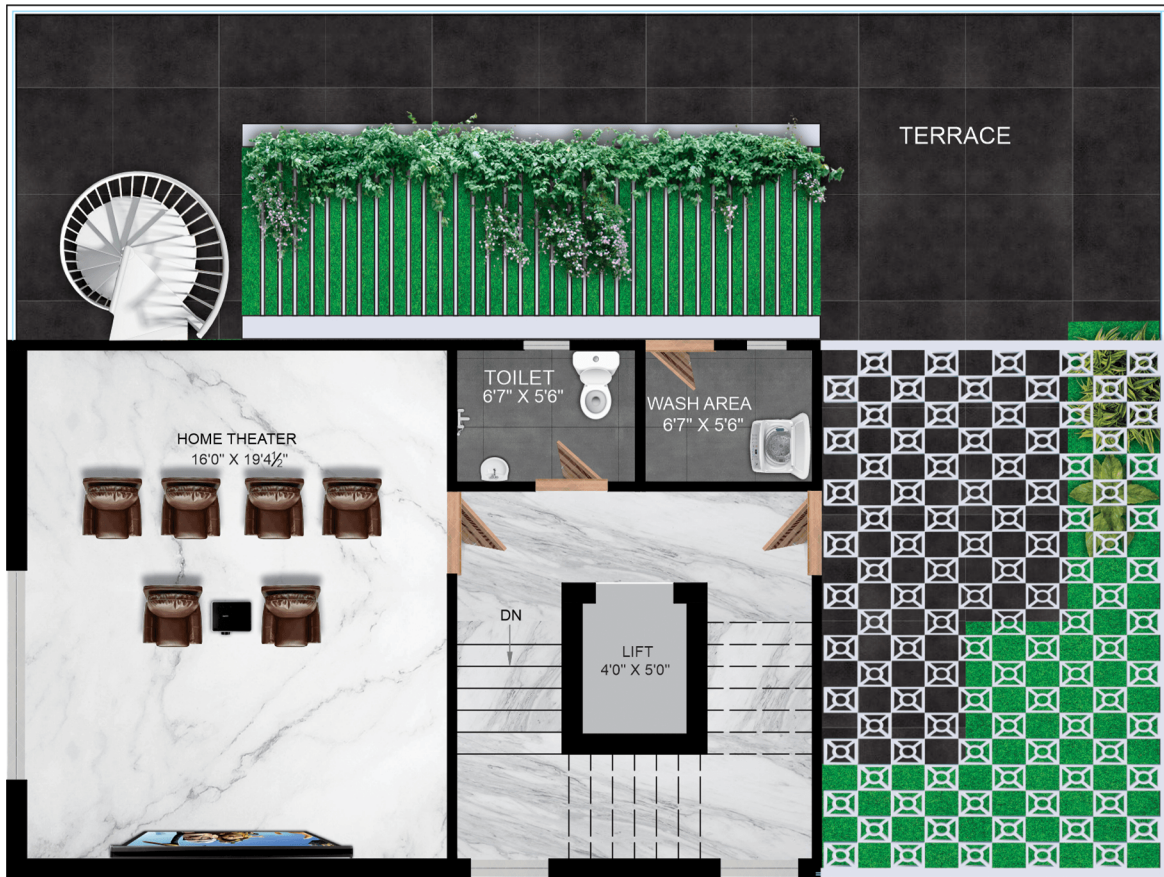

SECOND FLOOR

GROUND FLOOR

1471.31 sft

FIRST FLOOR

1471.31 sft

SECOND FLOOR

725.19 sft

TOTAL

3667.81 sft

CALM & SERENE

Pleasant, harmonious and peaceful place to live remains a goal for every home buyers.

NEELADRI VILLAS is the place you aspire

A perfect home is the one that resonates with oneself.

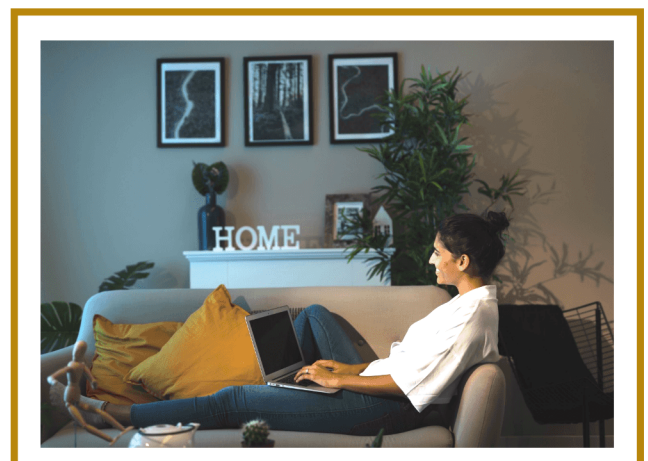

WEST FACING



GROUND FLOOR

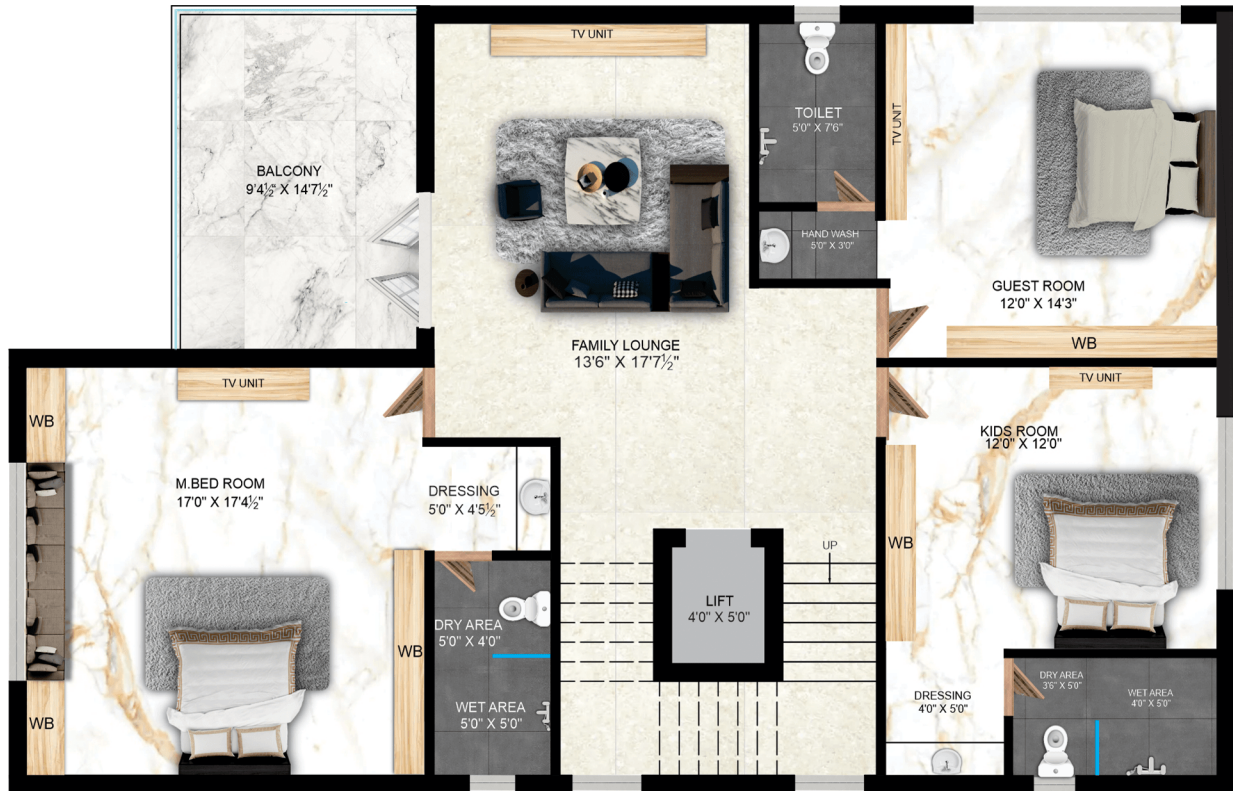

FIRST FLOOR

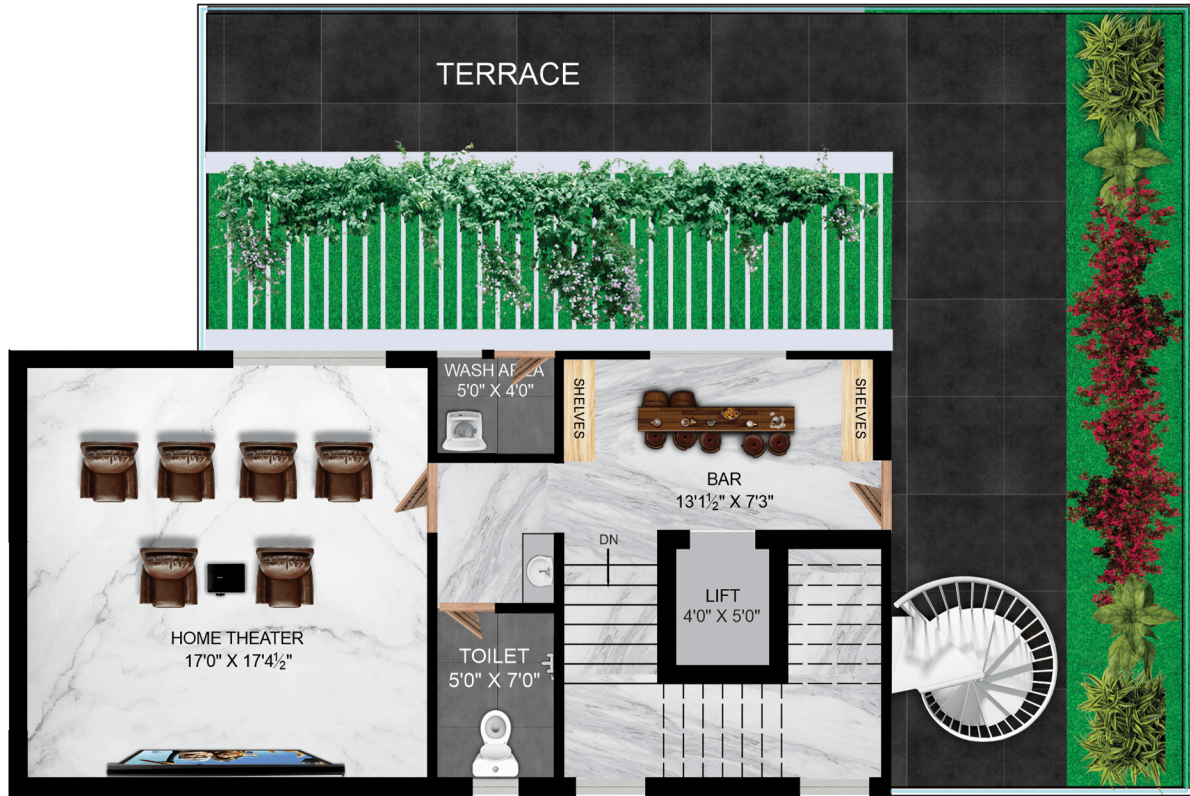

SECOND FLOOR

GROUND FLOOR

1399.19 sft

FIRST FLOOR

1562.19 sft

SECOND FLOOR

705.45 sft

TOTAL

3666.83 sft

MANIFEST YOUR GROWTH

Given the past developments and current trends in the area surrounding the location, you'll be part of one of the fastest growing real estate spots in Hyderabad.

Invest with us and be assured.





Sy. No. 208

OTHERS LAND

Sy. No. 209

AURVEDIC HOSPITAL

Sai baba temple
ಸಾಯಿಬಾಬಾ ತೆಮ್ಮೆ

PARK

BHASHYAM PIONEER COUNTRY

EXISTING 30'-0" ROAD

EXISTING 30'-0" ROAD

EXISTING 30'-0" ROAD

EXISTING 30'-0" ROAD

EXISTING 30'-0" ROAD

EXISTING 40'-0" ROAD

PROPOSED 40'-0" ROAD

PROPOSED 30' ROAD

PROPOSED 30' ROAD

PROPOSED 30' ROAD

EXISTING 40'-0" ROAD

EXISTING 40'-0" ROAD

WIDE ROAD

OTHERS LAND

Sy. No. 210

Sy. No. 197

PLOTS

PLOTS

OPEN SPACE
800.33 SQ.YDS
802.94 SQ.MTRS

LAND AREA TO MORTGAGE

GREEN TANK

SWIMMING POOL

WATER TANK

BIN

SLUMP

SEWER

WATER

CONNECTION

TO

ROAD

TO

ROAD

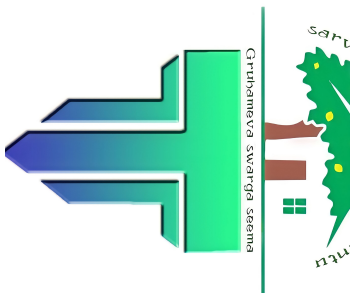
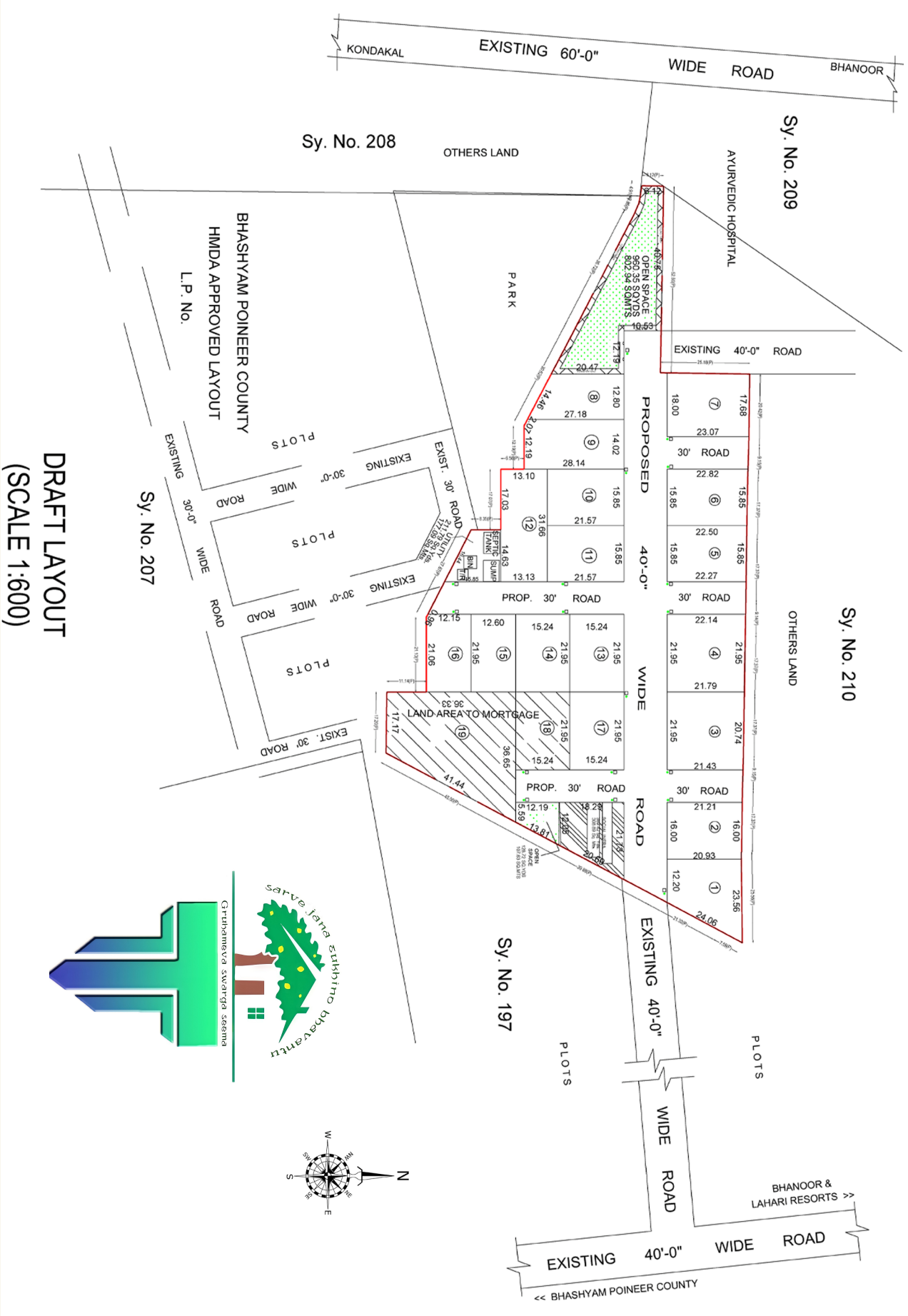

DRAFT LAYOUT
 (SCALE 1:600)

EAST FACING









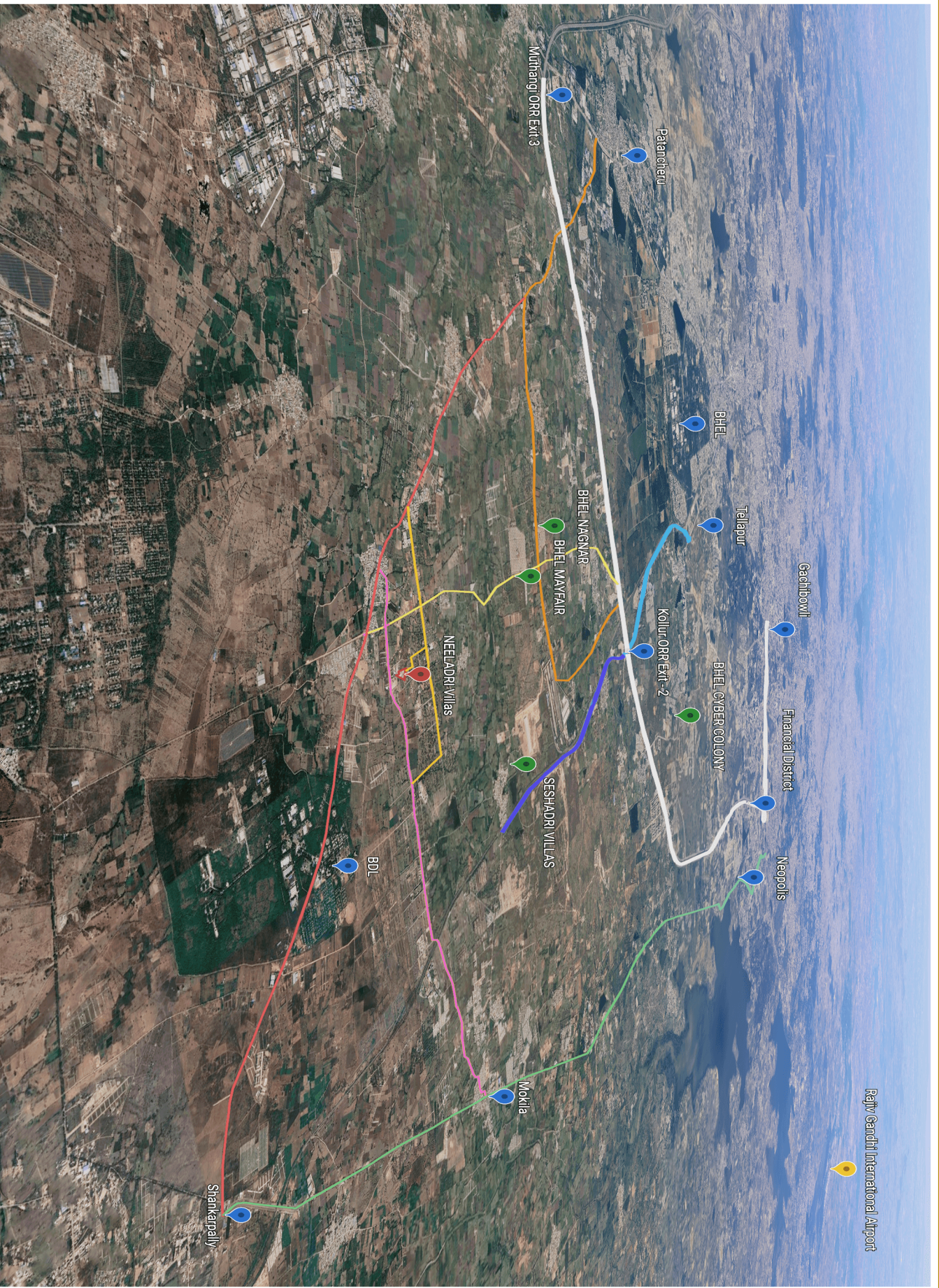

WEST FACING



THE GOLDEN TRIANGLE



-  Outer Ring Road
150m wide
-  Radial Road 7
30m wide
-  R R 7 Extn 100ft
30m wide
-  Visakha Road
60m wide
-  Patancheru to
Shankarpally 30m
-  Manjeera Road
30m wide
-  Bhanur to Mokila
30m wide road
-  Shankarpally to
Kokapet 30m

NEELADRI
— VILLAS —

TVRAO HOUSING

APPRECIATE THE GRANDEUR IN LIFE

Let us do the work, while you can prepare to enter your perfect home

DESCRIPTION

PRICE

Membership advance	20,00,000
Remaining Land Cost*	1,22,00,000
Construction Cost**	1,08,00,000
Total	2,50,00,000

*Extra Rs.250 for east facing,
Extra Rs.250 for corner plots

AVAIL UPTO 80% FROM BANK LOAN | SBI, HDFC

No hidden charges on amenities...

Account N°: 41557647391
Name: TVR HOUSING
Bank Name: State Bank of India
Branch: Ramchandrapuram (BHEL)
IFSC: SBIN 0020075

Send the transaction receipt for confirmation of
payments.

Only Cheques or Bank Transfers are accepted.

*Registration charge on land as applicable.

**GST 5% on construction cost. Labour cess as applicable.

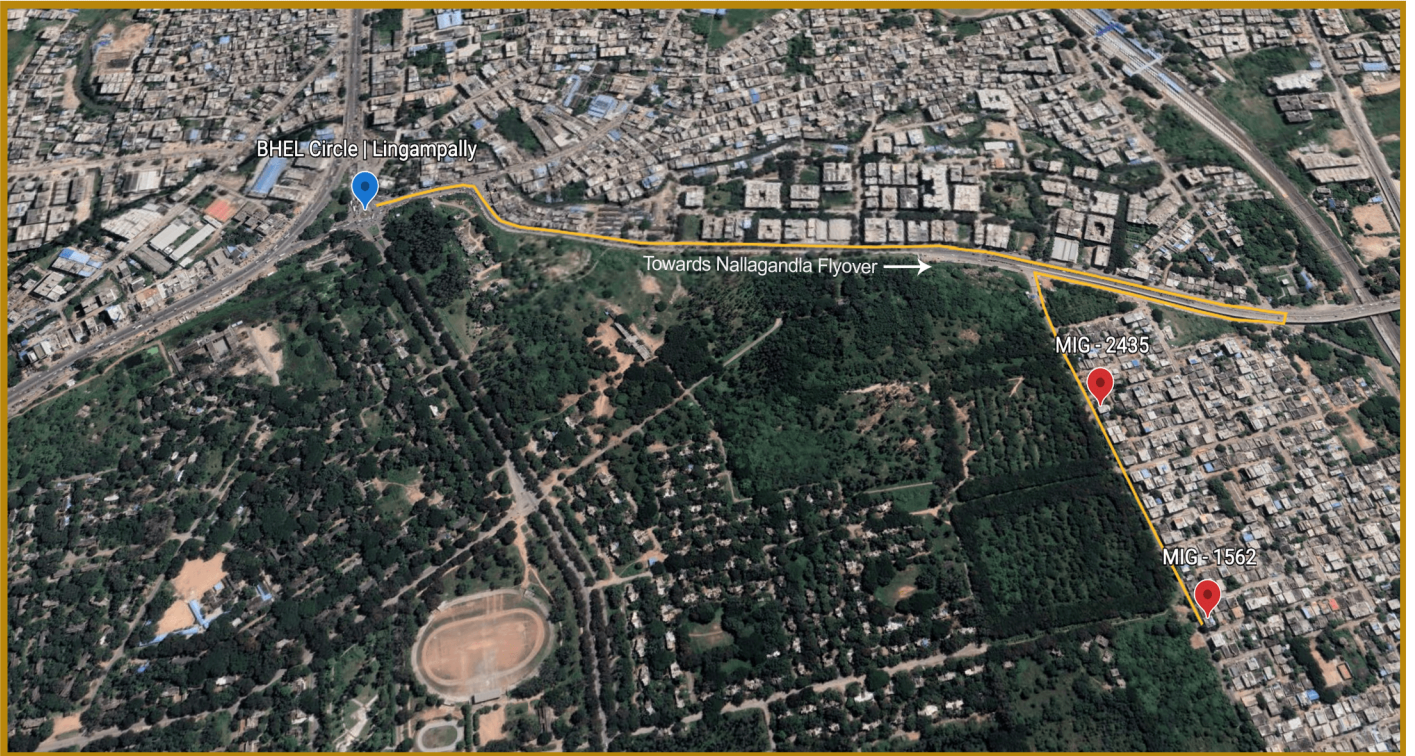

Total price is inclusive of Third Party PMC Quality inspection.



OFFICE LOCATION

 *Click here to navigate to office.* 

 *Click here to navigate to site.* 

 *Click here to watch Aerial View of the Site on youtube*
or visit 

www.tvrao.in | www.youtube.com/@tvrhousing

TVRAO HOUSING

H.No - 1562 & 2435, MIG Phase 1, BHEL, Serilingampally, Hyderabad, Telangana - 502032

CONTACT : 9849828088, 9492863051, 9494868859, 9440101206